

TRACK & FIELD

sportissima



ITALIAN
STYLE



Official Supplier of EUROPEAN ATHLETICS JUNIOR CHAMPIONSHIPS
RIETI 2013



INFO  sportissimo

Sportissimo is an Italian company born in 1979 from the sport passion of his founder, Dante Acerbis.

He started with the design and production of sport equipment for any kind of sports, but in the years he focused on track and field and made Sportissimo the first and only Italian company to produced iaaf homologated equipment.

We are the leading company in Italy and in the past years we develop the tecnology and knowledge to compete with al the other international companies.



Official Supplier



Official Sponsor





High Jump
Pole Vault
Long Jump
Triple Jump



Running
Hurdles
Steeplechase



Hammer
Discus
Javelin
Shot





High Jump
Pole Vault
Long Jump
Triple Jump

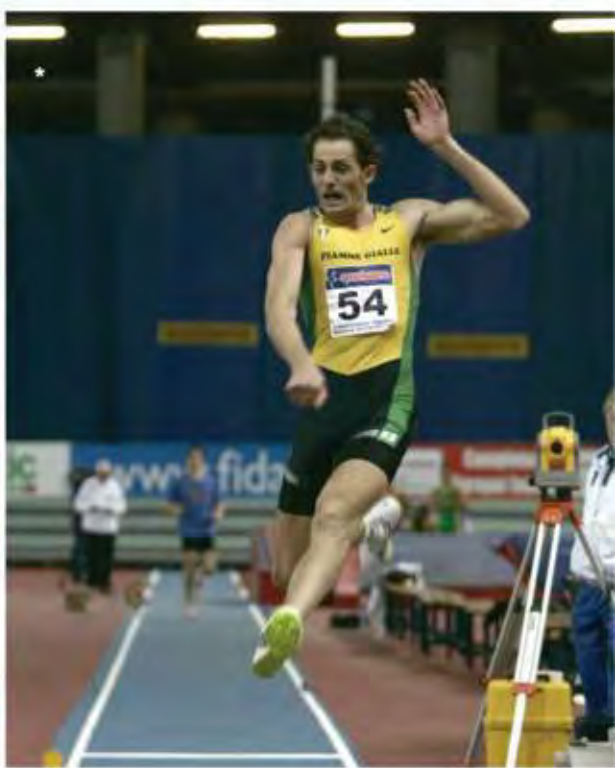

GOLD High Jump

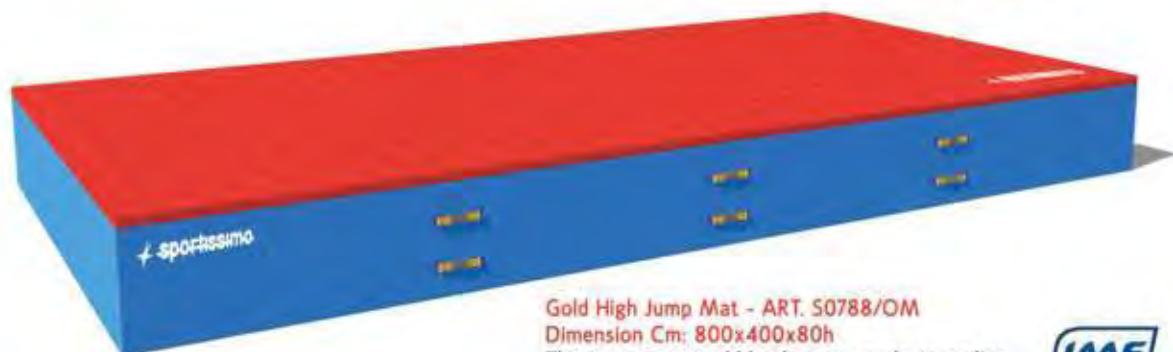

Gold High Jump Mat - ART. S0788/OM

Dimension Cm: 800x400x80h

This is our most sold landing pit, made according with iaaf rules. Composed from different blocks, each covered with pvc. Spikeproof mat, waterproof cover and uprights protections included.

IAAF Certificate in progress





SILVER High Jump



Silver High Jump Mat - ART.S0785/OM

Dimension Cm: 600x400x70h

Our most sold hj landing pit, made according with iaaf rules.

Composed by 3 blocks 400x200x63 each covered with pvc. Spikeproof 7 cm. mat covered with pvc net and waterproof cover included

IAAF Certificate n°: E-09-0558



BASIC High Jump

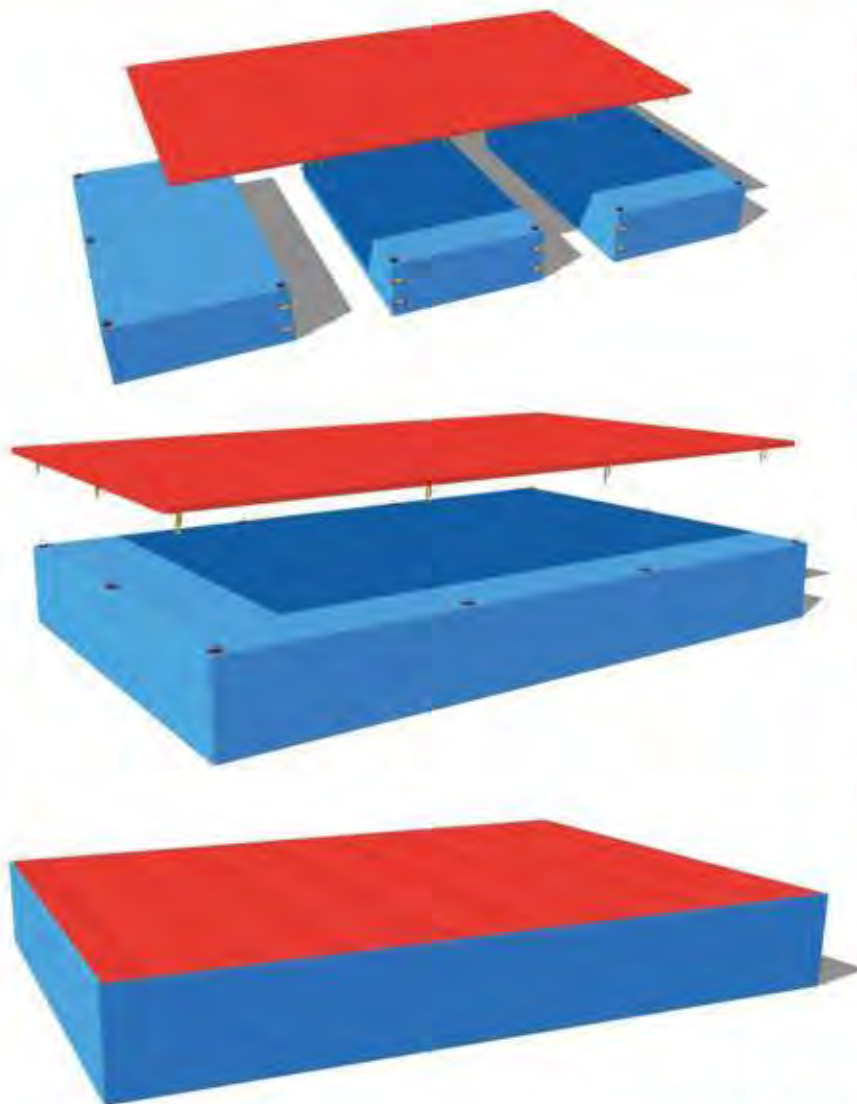

Basic HJ - MODULAR ART. S0777

Dim Cm. 600x350x53h
hj landing pit made by 3 blocks 200x350x53 each covered with pvc. Spike-proof 7 cm. mat covered with pvc net and waterproof cover included.

Basic HJ - SEMI-MODULAR ART. S0778

Dim Cm. 600x350x53h
hj landing pit made by a singular block 600x350x53 covered with pvc with on top a 7 cm. spikeproof mat covered with pvc net. The block and the spikeproof are 2 separate items. Waterproof cover included.

Basic HJ - MONOCUBE ART. S0779

Dim Cm. 600x350x53h
hj landing pit made by a monocube mat 600x350x60. The top of the landing pit it's made by pvc net so became a spikeproof area. Waterproof cover included

High Jump Garage - ART. S0787

Garage for landing areas removable mounted on rubber wheels diam. 30x5.

The structure is made of tubular galvanized steel, the cover is waterproof PVC sheet weight 720 gr

The garage can be opened on the front side so you can move it over the mattress when it is used.

The closure of the structure is completed by a lock that prevents possibility of using the mattress when not used. The cover presents a protections on edges, which is incorporated in the cover.





UPRIGHTS and CROSSBAR

High Jump Uprights Training ART. S0766

Uprights made of aluminum square section mm.35x35, with graduation centimeter and heavy "T" base, crossbar holder with flyers threaded H. 220/250 cm



High Jump Uprights Competition - ART. S0770

Uprights made of aluminum square mm.80x80, thickness 4 mm cut-out front with added sliders with dual support of the rod and double height reading so you can read at eye level even positioning of the crossbar above mt.2. Adjusting of the height from cm.60 to cm. 250. Heavy base "T" tubular steel 60x30 with three adjustable feet, bubble calibrated for a perfect verticality of the mast.



Crossbar Deflector - ART. S0755

Designed to avoid that the crossbar fall to the landing pit. The crossbar falls straight down to the edge of the landing mat without the hurt the athlete.

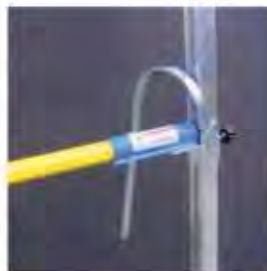

ART. N2126400



ART. S0772



Nordic High Jump Crossbar
ART. N2126400



Training High Jump Crossbar
ART. S0772

Soft Crossbar - ART. S0775

Elastic covered with foam, perfect for training



GOLD Pole Vault

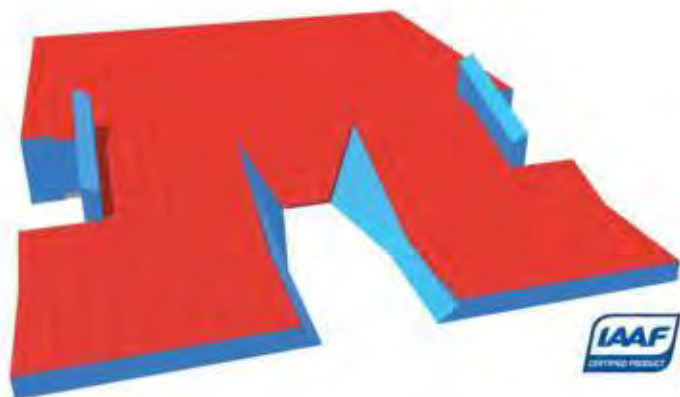

GOLD SET MAT

With this set of mats your Silver pole vault mat can become a gold pole vault landing pit

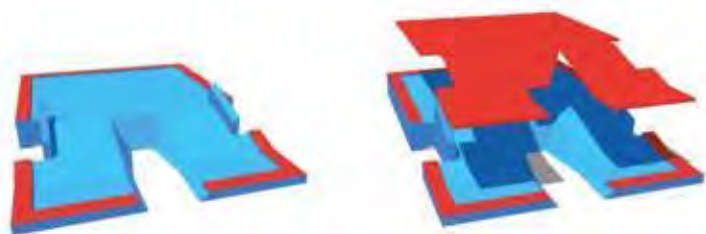

Gold Pole Vault Mat - ART. S0802/OM

Dimension Cm: 880x680x80h

Our new and biggest landing pit according with iaaf rules.

The mat is made by different blocks

covered with PVC, on top there is a 7 cm.

Spikeproof mat covered with pvc net.

Waterproof cover and uprights protection are included.

IAAF Certificate in progress





SILVER Pole Vault

Silver Pole Vault Mat - ART. S0821/OM

Dimension Cm: 800x600x80h

This is our most sold landing pit, made according with iaaf rules. Composed from different blocks, each covered with pvc. Spikeproof mat, waterproof cover and uprights protections included.

IAAF Certificate n°: E-99-0559

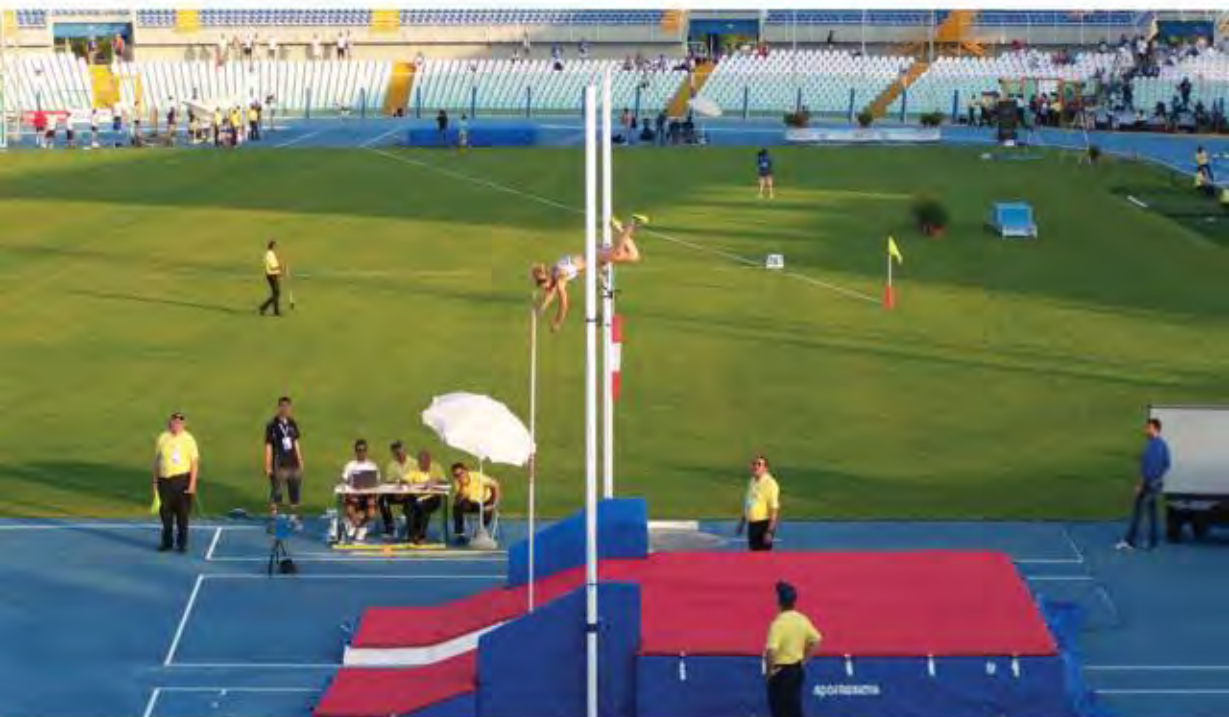

BASIC Pole Vault

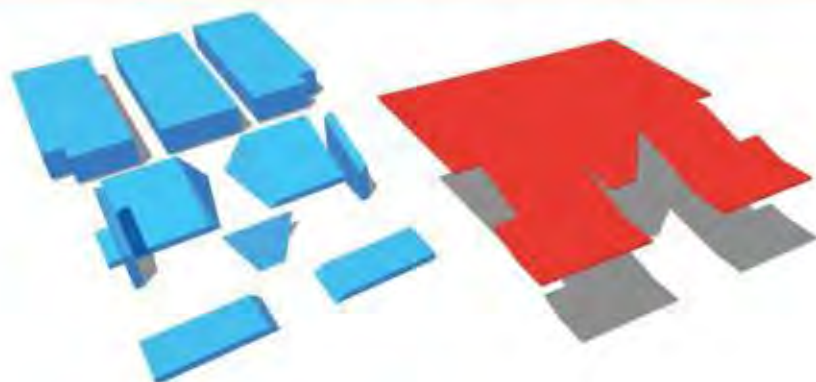

Basic PV - MODULAR ART. 50802

Dim Cm. 750x600x80h

Pv landing pit made from different blocks, each covered with pvc. Spikeproof mat, waterproof cover and uprights protections are included



Basic PV - SEMI MODULAR ART. 50801/B

Dim Cm. 750x600x80h

Pv landing pit made by a singular block 750x600x80 covered with pvc with on top a 7 cm. spikeproof mat covered with pvc net. The block and the spikeproof are 2 separate items. Waterproof cover included.



Basic PV - MONOCUBE ART. 50801

Dim Cm. 750x600x80h

Pv landing pit made by a monocube mat 750x600x80. The top of the landing pit it's made by pvc net so became a spikeproof area. Waterproof cover included

Pole Vault Garage - ART. 50787A

Garage for landing areas removable mounted on rubber wheels diam. 30x5.

The structure is made of tubular galvanized steel, the cover is waterproof PVC sheet weight 720 gr

The garage can be opened on the front side so you can move it over the mattress when it is used.

The closure of the structure is completed by a lock that prevents possibility of using the mattress when not used. The cover presents a protections on edges, which is incorporated in the cover.





UPRIGHTS and CROSSBAR

Pole Vault Uprights - ART. MAE110

Pair of uprights for the pole vault competition. Uprights made of anodized aluminum oval cross-section, graduation from Mt. 2 to mt. 6:50 by crank motion of metallic cog belts and pulleys and therefore exempt from slipping.

Aluminum telescopic rod holders rectangular, reading at head height, centimeter tape measure on polyethylene reinforced interior toothed metal wire width mm. 20.

Measured by means of locking the mechanical clutch. The uprights are attached to a trolley through pipes that give the vertical stability.

Cart for moving the upright in sturdy painted steel wheels with polyethylene sliding rail double "C" steel graduated from 0 to + 80 (according to the new regulation IAAF).

The block is done manually in a simple manner with an immediate reading on track for graduation centimeter. A shift occurred the carriage is stuck with a flyer.

IAAF Certificate n°: E-99-0188



ART. N3126450

noridcsporl.com

ART. S0771



Noridc Pole Vault Crossbar
ART. N3126450



Training Pole Vault Crossbar
ART. S0771



Pole Vault Box - ART. S0799

Made by strong aluminum, with fixation for concrete and water drain hole.

ACCESSORIES



Springboard - ART. S0810A

Springboard made by galvanized steel to support the mattress. Complete with lateral railings to contain the landing area.



Poles Rack - ART. C785

Powder coated steel rack to support athlete's poles



Poles Rack on Wheels - ART. C0786

Trolley for transport and positioning athletes poles, 6 shelves. Polycarbonete roof available.



Track Dryer - ART. BOWCOM

Foam roll mount on a steel frame, complete with handle for an easy movement. The system provides that the foam once it has absorbed the water is squeezed automatically so that the water may settle in a suitable tank and can start to dry the track. The water tank when filled has the ability to be downloaded with a tap.



Hj Measure - ART. S0813

Metric pole made entirely of aluminum, with bubble level for a perfectly vertical rod and appendix touches, telescopic, max measure possible mt. 3.0

LONG and TRIPLE JUMP



ART.0826



ART.S0825



ART.S0823



ART.S0831



Take Off Set for Long/Triple Jump

Take Off Board set made by 4 pieces:

- **ART. S0826** Stainless steel box to install in the ground. Measure cm. 122.5 x 30.5 x 11 H
- **ART. S0825** Stainless steel frame with adjustable feet and with screwed over a white 20 mm. marine wood board. Measure cm. 122 x 20+10 x 10 H
- **ART. S0823** Insert for plasticine made by marine wood contoured thickness mm. 20+7. Measure cm. 122 x 10
- **ART. S0831** Cover made by aluminum with adjustable feet. Measure cm. 122 x 30 x 10 H



Long/Triple Jump Protection - ART. S1700LPE

Modular protection to cover the edge of landing pit. Element made by polyethylene body colored, printed in a rotational system and internal foaming polyurethane foam. To fix by screws or dowels, Suitable for outdoor, weather resistant and sun rays. Average thickness of 4 cm, 5.5 cm x 15.5 sheltered corner. External dimensions 10.5 x 19.5 cm module length 150 cm.

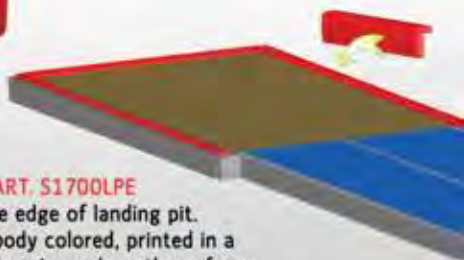

Long/Triple Jump Indicator Board ART. S0819

Measuring board for long and triple jump. Made by foam and covered by pvc. Indicate the distance of the jump from the take off board. Movable numbers.



Laser Measuring Device
ART. SDTM332

Optical laser instrument linked to a handheld device. The best and most accurate device to measure jumps. It's possible to connect directly to scoreboard, database and announcer computer.



Gazebo - ART. QT3030

Very strong and resistant gazebo, made by anodized aluminum frame, covered with fireproof and waterproof polyester. Adjustable legs and stabilizers feed. Perfect for fields event to protect the athletes for sun or rain. Available in different colors and measure (mt. 3x3 / 4.5x3 / 6x3). Customization are available



Umbrella - ART. 50606

Cotton umbrella perfect for repair athletes or judge form sun, complete with concrete base.



Sand Rake - ART. C0829
Sedge Broom - ART. C0830



Athletes Bench - ART. S1567

3 mt. beach for athletes. Made by steel frame with over a wood board design to stay outdoor and indoor.



Long/Triple Jump Indicator Board
ART.

Measuring board for long and triple jump. Made by foam and covered by pvc. Indicate the distance of the jump from the take off board. Movable numbers.



Measuring Tape
ART. S0616M
Steel and fiberglass measuring tape with handle (10-20mt.)

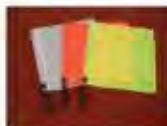

Judge flags
ART. C0593-4-5
Made by plastic handle and nylon flag. 3 different colors available red, yellow, white.



Runway Marker
ART. S1350
Markers for long/triple jump and pole vault. Different colors available. Made by steel.



STEPPECHASE



Steeplechase Hurdles - ART. S0565

Movable obstacle with 2 different heights 76.2 for females, 91.4 for males, adjustable to means of telescopic stands with ratchet spring and automatic wheel clamping. Black and white treated wood beam mount it over galvanized steel legs. Thickness cm. 12.7x12.7, length mt. 3.96 / 5.00

IAAF Certificate n°: E-09-564 SPORTISSIMO



Waterjump Steeplechase Hurdle - ART. S0568

Obstacle with 2 different heights 76.2 for females, 91.4 for males, adjustable to means of telescopic stands with ratchet spring and automatic wheel clamping. Black and white treated wood beam mount it over galvanized steel legs. Thickness cm. 12.7x12.7, length mt. 3.66.

IAAF Certificate n°: E-09-565 SPORTISSIMO



HURDLES



Competition Hurdle - ART. N1132OHR

Our most sold hurdle according with iaaf rules. Made by 50 mm. steel tubes base , aluminum sliding pipes and strong plastic crossbar. Adjustable to 6 different heights (from 68.6 cm. to 106.7 cm.) complete with an easy selector system to adjust weight at the required height.
 IAAF Certificate n°: E-01-0325



Hurdle Crossbar - ART. S0562P
 Made by strong reinforced plastic



Stainless Steel Hurdle ART. S0623

Our brand new hurdles according with iaaf rules. Frame made completely of stainless steel with strong plastic crossbar. Adjustable to 5 different heights (from 76 cm. to 106.7 cm.) complete with an easy selector system to adjust weight at the required height.



HURDLES junior models



Junior Hurdle

Galvanized steel frame, adjustable height, crossbar covered with polyethylene foam covered with PVC.

Height adjustment by means of stainless steel ratchet type of extraction. 3 different models available:

ART. S0557B cm. 40/50/60

ART. S0558B cm. 50/60/76.2

ART. S0559B cm. 60/76.2/84/91.4



Hurdles Carrier Cart - ART. 0563

Powder coated steel frame mounted over 20cm. wheels. Sliding rails capacity: 30. Complete with handle or golf cart junction.



Foam Hurdle

ART. 51206

Assembled preparatory hurdle made by polyethylene foam, adjustable heights 18/34/50 cm.



Mini Hurdle - ART. S0556

set of 10 mini hurdle made by powder coated steel. Height increasing cm. 12/14/16/18/20/22/24/26/28/30



STARTING EQUIPMENTS



Starting Block Olympic - ART. N1132PR

Super heavy duty block especially designed for top athletes.

All Aluminum block with center rail 100 mm wide x 900 mm long and slotted angles to firmly grip Block. Adjustable at four different angles.

All blocks fitted with special thick rubber to take in spikes.

Suitable block for synthetic track

IAAF Certificate n°: E-99-0130



Starting Block Pro - ART. N1131OSV

Starting block in aluminum with light pedals and 75 mm aluminum central rail.

IAAF Certificate n°: E-10-0592

Starter Stand - ART. C0588
Made by tubular steel powder coated with epoxy, No. 2 steps covered in laminated stratified, balustrade parapet front, complete with wheels for an easy movement.



Lane Markers

ART. S0651B

White plastic cube
cm. 40x40x40.

Numbers from 1 to 9



Basket for Clothes

ART. S0627

Stackable basket made by strong plastic, complete with 2 holes on the sides for the hands.



Megaphone

ART. S0589

battery megaphone
complete with hand mike



Ciak

ART. CIAK



RUNNING



Judges Stand - ART. C0579
Stand made by galvanized steel complete with 6 plastic seats UV rays resistant and antislip viremesch wood steps. Mount it over pneumatic wheels for a easy movement.



Lights Bridge - ART. C0622
Lights bridge to install over the finish line. Reticular structure in painted steel. Width mt. 10, high mt. 3. Complete with nr. 6 150 watt lights.



Relay Baton
ART. N1132B
Fully made by aluminum



Podium - ART. C05900
Podium with marks for 1°, 2° and 3° place, structure in painted iron; 3 floors cm. 80x80 made by antislip wood or separate small wood beams.



Race Numbers
ART. PETT
Made by tyvek.
Customization available



Pins - ART. PINS
Safety plastic pins.
Customization available



Lap Counter
ART. C0573
Lap counter with brass bell, mount it over heavy steel base.



Finish Line Posts
ART. S0572
Galvanized steel posts mm.80x20, complete with sockets



DISCUS CAGE

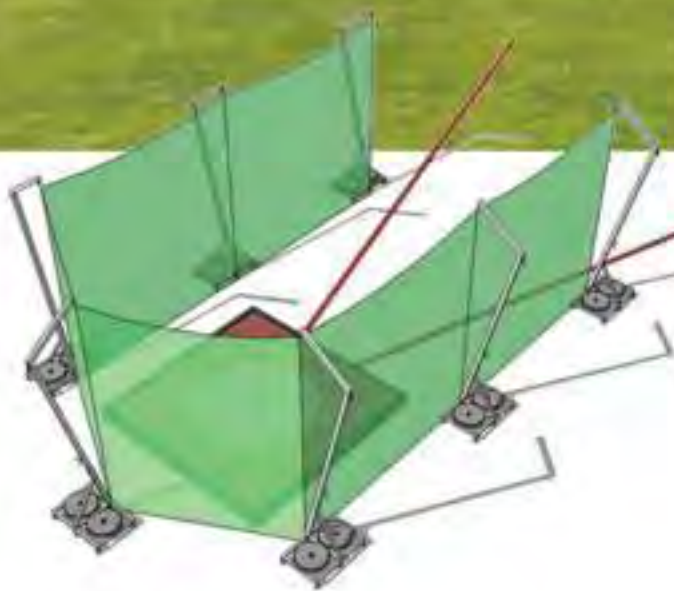

Discus Cage - ART. S0667_10 / ART. S0668_10

The cage has a warmth galvanized steel structure, and is built with upright mm. 60x60 section, thickness mm 3.

Formed by:

- N. 7 poles, height out of ground m 4.5 connected by double braces in tubular galvanized steel. Each post is equipped with a pulley with rope 12 mm to be able to raise and lower the net
- At the base of each pillar there is a bracket with ring to attach the net to the ground
- To each pole is suspended through a system of rope and pulleys, a safety nylon net square mesh size 48x48 mm. Measure mt. 25 x 4.5 H
- Underground sockets or self-supporting bases complete with concrete ballast.

The particularity of this cage is that the net is suspended and is not supported by the poles, thus avoid the possibility that the hammer, when it is launched in the cage, hit the iron structure and the net and after many throws, they could be deformed leaving the cage in bad conditions.

To avoid this issue the poles have 50 cm. arms that suspend net and iron wires that give to the net more secure and more durable.



HAMMER CAGE



Hammer Cage - ART. S067_10

The cage has a warmth galvanized steel structure, and is built with upright mm. 80x80 section, thickness mm 3.

Formed by:

- N. 6 small poles, height out of ground m 7 connected by double braces in tubular galvanized steel. Each post is equipped with a pulley with rope 12 mm to be able to raise and lower the net
- N. 4 high poles, total height out of ground m 10, in 2 pieces (upright + extension)
- The first and the tenth pole are hinged n. 2 front panels dimensions 2,10 m x10, open with the support of wheels diameter 28 cm.
- To each pole is suspended through a system of rope and pulleys, a safety nylon net square mesh size 48x48 mm. Measure mt. 31 x 7/10 H
- Underground sockets



The particularity of this cage is that the net is suspended and is not supported by the poles, thus avoid the possibility that the hammer, when it is launched in the cage, hit the iron structure and the net and after many throws, they could be deformed leaving the cage in bad conditions. To avoid this issue the poles have 50 cm. arms that suspend net and iron wires that give to the net more secure and more durable.

IAAF Certificate n°: E-09-560

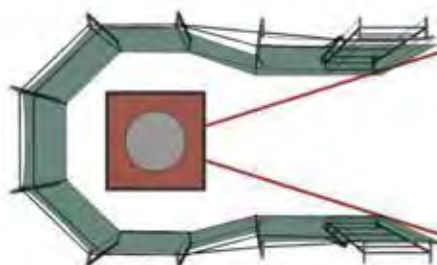
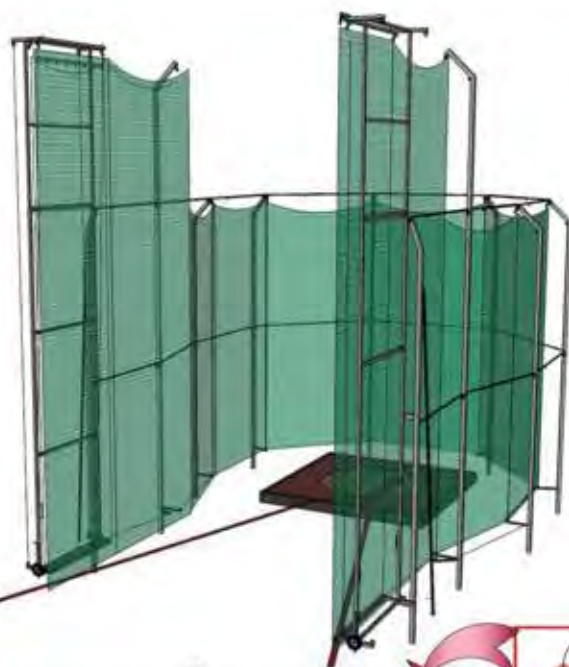

For the making of the giraffe you have to use:
 * concrete C20/25 with Rebar Ø20 or Ø25x120H
 * bars made of steel Ø4500 with adhesion with f.p. 4500 of stainless

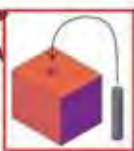
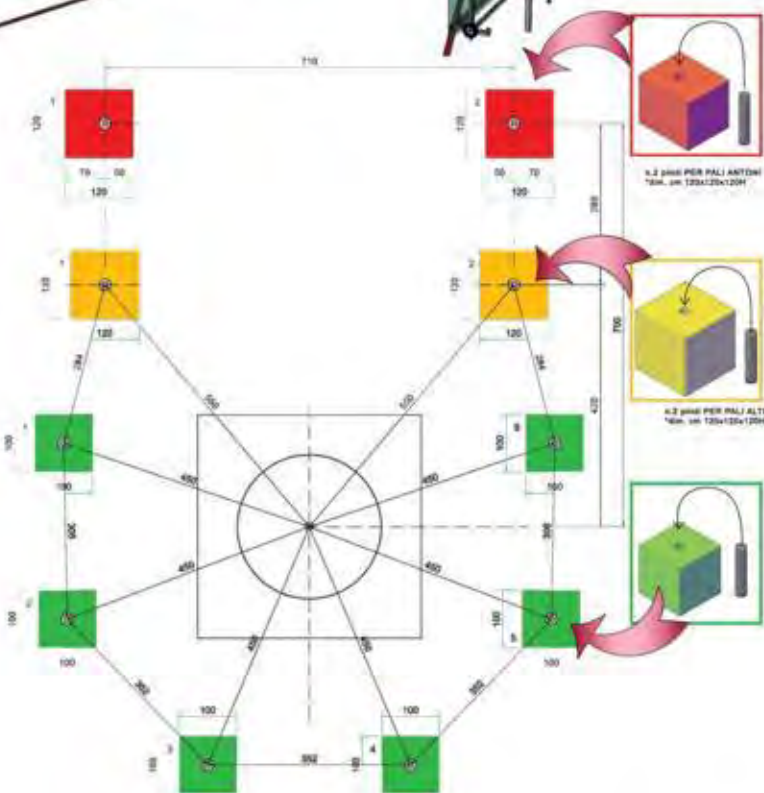

n.2 giro PER PALI ANTONI
 *dim. cm 120x120x120H



n.2 giro PER PALI ALTI
 *dim. cm 120x120x120H



n.8 giro PER PALI BASSI
 *dim. cm 100x100x100H

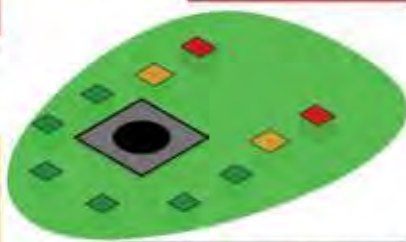

* DIMENSIONS RELATED TO THE CENTRE OF THE GROUND SOCKET
 * TO ARRANGE PVC PIPE Ø mm 200 LOW cm 60.
 * THEN BRICK IN THE GROUND SOCKET Ø mm 127



INDOOR CAGES



Indoor Hammer/Discus Cage
ART. C000669

The cage it's made by powder coated steel reticular structure that it's hang at the roof with strong chains. Attached to it there is a safety nylon net square mesh size 48x48 mm (fire-proof if required). At one side there is an engine that can lift up and down the net so when the cage it's not used, you can have an open space to warm up or training. The perfect cage for throw in safety discus and hammers.



Shot Put Indoor Cage - ART. C000668

The cage it's made by powder coated steel reticular structure that it's hang at the roof with 8 strong chains. The structure has a U shape length mt. 15+9+15 according with IAAF rules. Contain perimeter made by wood apply over 50 cm. steel uprights, easy connection and disconnection type bayonet to be able to disassemble and reassemble quickly. Nylon net white mesh 4,8 x4, 8 mm.5 braid like the hammer throw (certified for shot put) complete with special hooks and straps to be able to attach to the structure "U" shaped top or plinth bearing on the ground. Complete with soft mats which gives a shot mark that can be measure.



Shot Put/Hammer Indoor Circle
ART. C002772

Movable shot put indoor circle mount it over a paint wood board. Complete with handle. Toe board or concentric circle included.

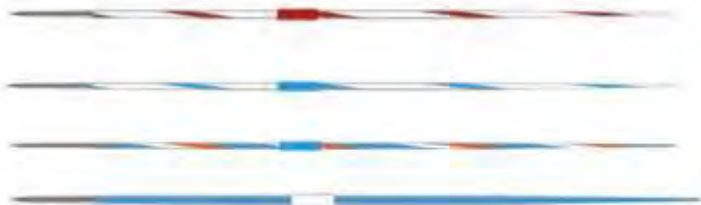

Official provider of Nordic Javelins

With our knowledge we will support you to find the perfect item for your needs. From basic to high quality homologated javelins.



Official provider of Nordic and Nelco Shots/Discus/Hammers

From basic items for beginners to homologated for top class athletes, we can provide any solution that you need.

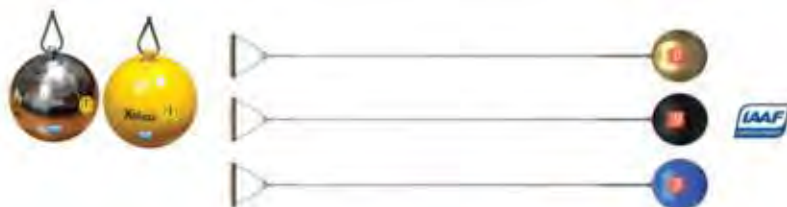

THROW ACCESSORIES



Hammer Concentric Circle
ART. S0652

Adapter for hammer platform, made by 4 painted wood pieces. Completed on the side with screws to adapt the circle at the platform on the best way possible.



Toe Board
ART. S0739

Toe board for shot put mad by fiberglass filled with foam for a greater resistance.



Throwing Rings

- **ART. S0646** Powder coated steel discus ring for setting in concrete, made by 2 different pieces.
- **ART. S0737** Powder coated steel shot put ring for setting in concrete, made by 2 different pieces.



- **ART. S0647** Powder coated steel discus ring to be screwed to the concrete platform. Made by 3 different pieces. Profile mm. 20x20
- **ART. S0738** Powder coated steel shot put ring to be screwed to the concrete platform. Made by 3 different pieces. Profile mm. 20x20



Chalk Bowl
ART. S2860



Discus Cart
ART. C0653

Powder coated steel cart on wheels for discus transportation.



Javelins Cart
ART. C0670

Powder coated steel cart on wheels for javelins transportation.



Shot Put Return System
ART. C0672

Powder coated steel profile to carriage for shots during competition.



Hammers Cart
ART. C0670

Powder coated steel cart on wheels for hammers transportation.



Shot Put Cart
ART. C0741

Powder coated steel cart on wheels for shots transportation.



Electric Car
ART. 500CAR

Little electric car to carriage throwing items (hammers, discus, javelins). Complete with batteries and chargers. Transmitting commands by means of radio control. The perfect item for transport long the field all the throwing materials.



Laser Measuring Device
ART. SDTM332

Optical laser instrument linked to a handheld device. The best and most accurate device to measure jumps. It's possible to connect directly to scoreboard, database and announcer computer.



Throwing Markers
ART. S0648

To mark a length of individual throws, made by galvanized steel and with handle. Height cm. 30.



Sector Lines Tape
ART. S0600

Made by nylon, 5 cm. wide, 50 mt. roll

Sector Tape Roller Spools
ART. S0603
Capacity mt.100



Distance Marker
White plastic cube
cm. 40x40x40.

ART. S0651

Shows every 10 meters from 30 to 90

ART. S0650

Shows every 1 meter form 12 to 23



Scales - ART. S0609
High precision scales
1 gram sensitivity



Throwing Gauges
ART. S0645
Full set of steel throwing gauges for hammer/discus/shot put/javelin.



Measuring Tape
Steel and fiberglass measuring tape with handle.

-ART. S0617: 50mt.

-ART. S0618M: 100mt.



TRAINING



Slide
ART. S0630
Sprint training steel slide with the possibility to add over weights



Weighted Belt
ART. S2002
Anatomic heavy training belt for improve the athletes power during jumps or running training. Kg. 5



Super Speed Elastic - ART. S0785
Nylon belt with strong tubes elastic for super speed training

Weighted Jacket
ART. S2003
Anatomic heavy training jacket for improve the athletes power during jumps or running training. Kg. 10





Cubes - ART. S2098/S2100/S2101
Set of 3 cubes at different heights (cm. 20/40/60)
made by powder coated steel frame, 120x100 cm.
Wood board with over a piece of tartan. Indicated for
jumps training.



Medicine Balls
Available from 1 to 12 kg



Proprioceptive Disk
Design for feet, ankles and knees
rehabilitation



Training Ropes - ART. S0081



Elastic Tubes
ART. S0540
ART. S0541



Parachute - ART. NAR002
Like the steel slide it's design for
improve the power athletes during the
sprint training



Multipower Press
ART. VRE129



Weightlifting Bars
Available 2 different diameter
-ART. 21134QF - 25 mm
-ART. 21134R1 - mm.50



Weightlifting Discs
kg.available from
0,5 to 25.
Hole mm.25 or mm.50

COACH KIT



Whistle - ART. S1220
Chronometer 200 Memory - ART. DMT58-200





Kids laaf - ART. T02-15059

The most famous track and field kit provide from IAAF. Design to approach the kids to the athletics world. The kit Provide many solution and games for the kids and help them to learn the basic movement of sport: run, jump and throw.



VORTEX - ART. 50679

Propaedeutic javelin for kids. Designed it to teach the movement and technical of the javelin throw to young athletes.
Weight 150 gr.

REFERENCE



- 2007 EAA European Cup Milan (ITA)



- 2009 Mediterranean Games Pescara (ITA)



- 2009 IAAF Youth World Championship Brixen (ITA)



- 2009 IAAF Final Grand Prix Thessaloniki (GRE)



- 2009 EAA European Indoor Championship Turin (ITA)



- 2008/2009/2010/2011/2012/2013
IAAF Diamond League Golden Gala Rome (ITA)



- 2013 EAA European Junior Championship Rieti (ITA)



- CIO Olympic Training Center Formia (ITA)



- Swiss Federation Indoor Training Center Tenero (SUI)









 **sportissimo**



Via Pradella 10 - 24021 ALBINO BG - Italia
Tel. +39.035.752.722 - Fax. +39.035.774.102
info@sportissimotnt.it - www.sportissimotnt.it

Sportissimo

- Sport equipment for every sport
- Homologated equipment for track and field and gymnastic
- Mattress and landing pit
- Multisport areas and playground
- Soft surfaces for playground and water park
- Hi-quality wall protection



Organizzazione con Sistema per
la Qualità certificato
UNI EN ISO 9001:2008

Safety and services

- Equipment installation service
- Safety Adjustment service for sport facilities
- Testing and certification of static suitability
- Assistance and maintenance projects

Sport Events

- Custom banners and flags for sports events and promotion
- Event fences and protections
- Rentals and installation:
 - Gymnova full competition area
 - TimeTronics scoreboard and timing system
 - Temporary outdoor sport fields (basket, soccer, volley, track and field ...)

